

**Material Features :**

- High-pressure die-casting aluminum case, treated with anti corrosion electrostatic powder painting
- High temperature-proof silicon gasket, Tempered safety glass Plus Stainless Steel guard web.
- High purity aluminum pre-anodized reflector with built-in dark slide.
- Scale Plates in both sides, Convenient to adjust projecting reflector
- Bulbs changeable in the back opening, easy maintenance

**Applicable places :**

- Illumination of the Stadium(Football, Cricket, Tennis, Volleyball etc) Golf Course, Race Course, Pier, Plaza etc.

IP65 Class I    

**ELGT24**

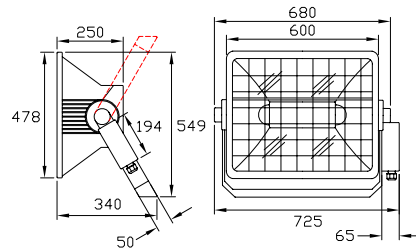

Light Distribution Curve (Cd/1000lm)

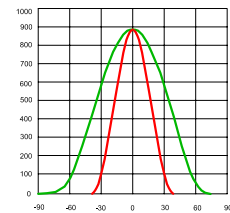

**ELGT25**

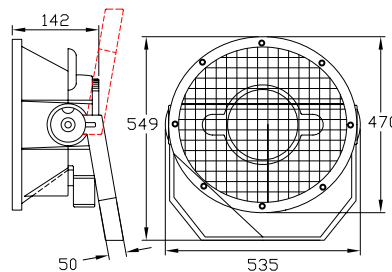

Light Distribution Curve (Cd/1000lm)

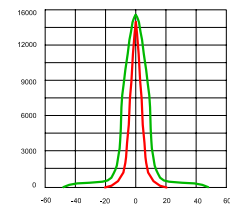

Model No	Light Source	Power W	Power factor pf	Input Voltage V/Hz	Lamp Type	Lamp Life Hr
ELGT24	HPS/MH	1000/ 1000~2000	>0.85	220~240V/ 50-60/Hz	E40	24000 / 12000
ELGT25	MH	1000~2000	>0.85	380~415V/ 50-60Hz	X528	12000

## Control Gear Boxes

**ELDK7**

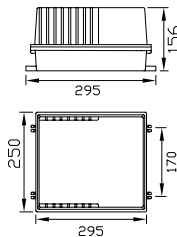

**ELDK6 I**

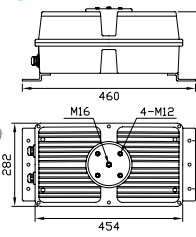

**ELDK6 II**

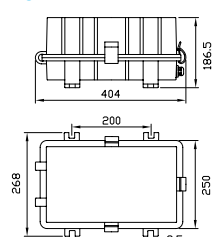
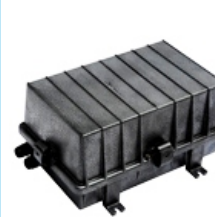

Model No	Power	Material	Overall Dimension	Fixing Holes
ELDK7	1000	Die-cast Aluminum	295X250X156	275 X 170
ELDK6 I	2000 / 2X400	Die-cast Aluminum	460X282X205	454 X 160
ELDK6 II	2000 / 2X400	Die-cast Aluminum	404X268X186.5	200 X 250